

Typical Recessed Electricity Meter Box Installation

38mm Electricity Hockey Stick
Product Code EC1002(white)
EC1001(black)

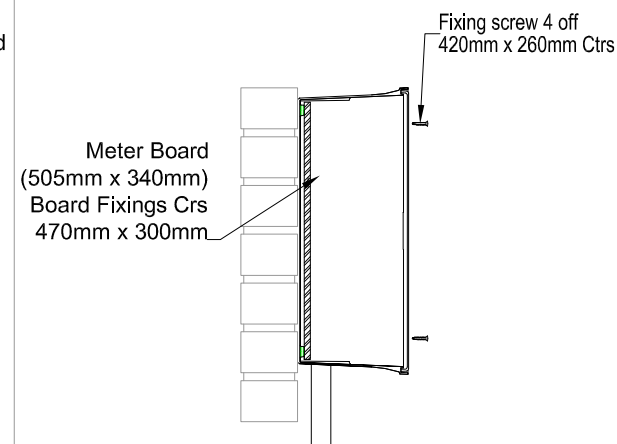

Surface Mounted Electricity Meter Box

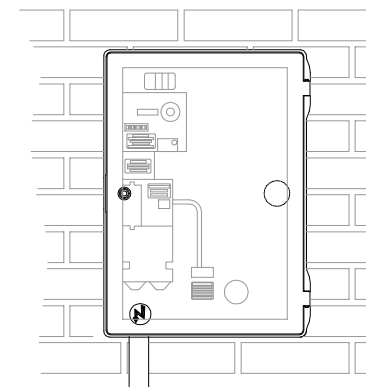
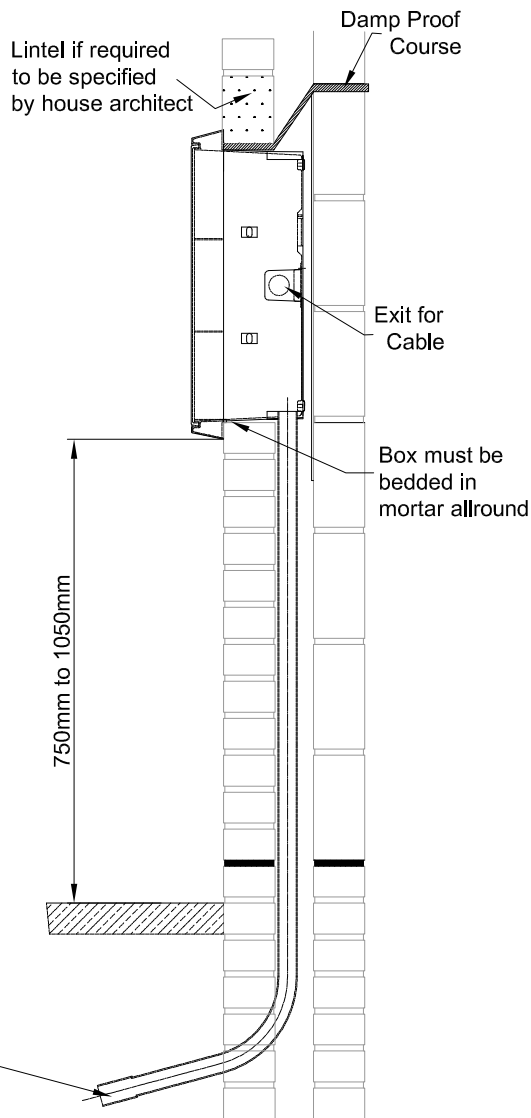
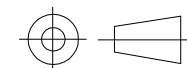

Drawn	By: OEL	Date: 26/08/10	All dimensions in mm Unless otherwise stated, general tolerance \pm		Part Number:
QA approval	BS EN 9001		Rev. No.	TITLE:	N/A
Mould No. / Eng Dwg. No: F/Eng/	Scale: NTS	MATERIAL: DMC	000	Typical Electricity meter box installations	

Tricel reserves the right to change the specification without prior notification.

Note. For products with 7 digit part numbers, the first digit represents a colour other than cream.e.g. 9 = GREY

