



The AquaSafe Alarm high water level alarm with an 85 dB audible alarm and LED status display.

It also features three volt-free contacts for connection to building management systems and other remote monitors.

The AquaSafe Alarm alerts the end user when:

- there is a power failure to the alarm
- there is a high level condition in the chamber
- a previous high level condition has been recorded
- a service visit is due

The panel features a trickle-charged battery so that it can continue to monitor the pumping station during periods of mains power failure for up to 24 hours.

The system activates via a mini float switch which is located inside the pumping station. It is set to activate higher than the activation point of the primary pump.

For groundwater and surface water applications where inflow cannot be controlled, a high level alarm should be used, in accordance with BS 8102:2022 and PCA Guidelines.

KEY FEATURES

- Three volt-free contacts for connection to external systems
- Quick and simple installation
- Can be retrofitted
- An internal battery ensures the alarm can operate for 24 hours in the event of mains failure
- LEDs shows status and alert conditions
- Mute and reset buttons
- Includes a mini float switch with a 10 m cable

WASTE TYPE



Grey Ground Surface Storm

This system is not suitable for foul waste. Contact our Sales Team for advice on a suitable foul water high level alarm.

RECOMMENDED ACCESSORIES

6 V, 1.3 Ah battery



106992

EXAMPLE INSTALLATION

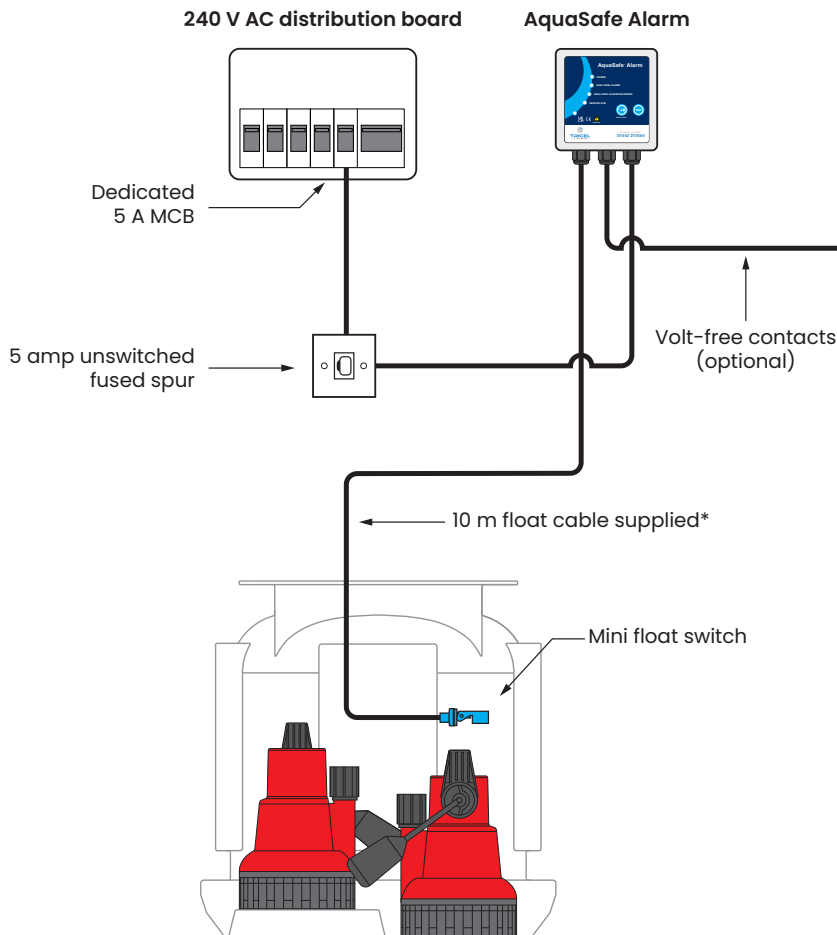

* The float comes with a 10 m cable. A cable extension and junction box (not supplied) is required if the alarm is installed more than 10 m from the base of the chamber.

PANEL SPECIFICATIONS

Power supply	230V AC 50Hz
Rated power	<10 VA
Internal battery	6 V, 1.3 Ah
Sound alarm level	85 dB
Power cable length	1 m
Weight	0.5 kg
Material	ABS
Colour	Grey
Operating temperature	-10°C to +40°C

PANEL DIMENSIONS

Height	122 mm
Width	124 mm
Depth	85 mm

VOLT-FREE CONTACTS

The AquaSafe Alarm has three volt-free for connection to remote telemetry or a building management systems. They can be set to Normally Open (NO) or Normally Closed (NC) depending on external system requirements.

- High level volt free contact
- Power fail volt free contact
- Service due volt free contact

CONFORMITY

- The Low Voltage Directive, EN61010:2010.
- The EMC Directive EN55014:2006, A1 and EN55014-2:2015.

